

EXPANZO

THE COMPLETE EXPANSION JOINT SYSTEMS

WWW.EXPANZO.COM

EXPANZO FRWS SERIES

(Floor To Wall Expansion Joints-Surface Mounted)



Ideal for managing both fixed and movement types of floor-to-wall expansion gaps, this product offers a reliable and versatile solution for various construction needs. It is equipped with a high-strength architectural aluminum base frame and cover, which provide exceptional durability and protection. The design prevents damage to waterproofing tapes, ensuring that the waterproofing system remains intact and effective over time. Additionally, the product ensures precise exposed coving for expansion joints, contributing to both the structural integrity and the aesthetic quality of the construction

FLOOR TO WALL EXPANSION JOINTS-
SURFACE MOUNTED

expansion joint system is designed with beveled edges for pedestrian safety and easy installation. The perfect economical solution for retrofit and surface mount installations.



APPLICATION AREA	INTERIOR AND EXTERIOR FLOORS
INSTALLATION TYPE	SURFACE MOUNTED
LOAD CAPACITY	HEAVY VEHICULAR TRAFFIC
SUITABLE FOR	RESIDENTIAL,COMMERCIAL PARKINGS PODIUM,DRIVE WAY, STADIUM
MATERIAL	FULLY ALUMINIUM
THICKNESS	3MM & 4 MM
SIZE	150MM to 500 MM WIDTH
COVER FINISH	MILL FINISH
OPTIONAL VAPOR BARRIER	EASY TO INSTALL

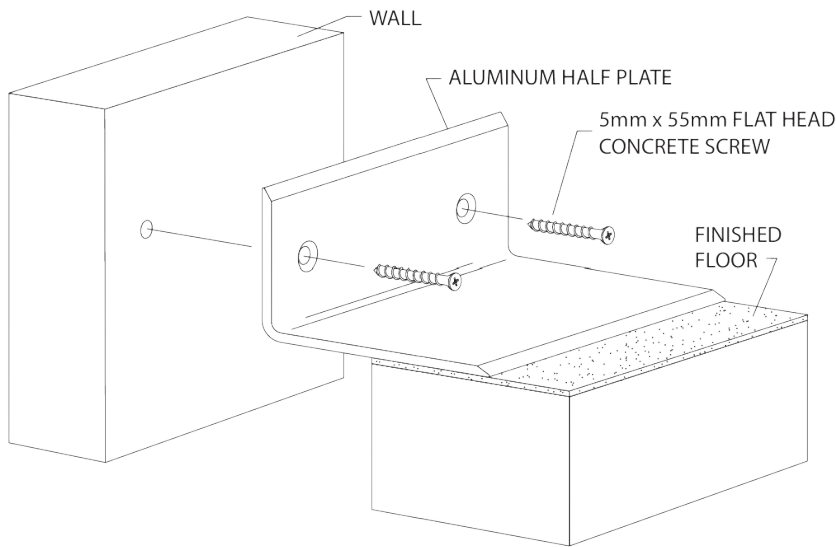

Install the architectural joint system on a leveled, finished floor. This may require grinding or applying a leveling compound on top of the substrate to create a smooth mounting surface

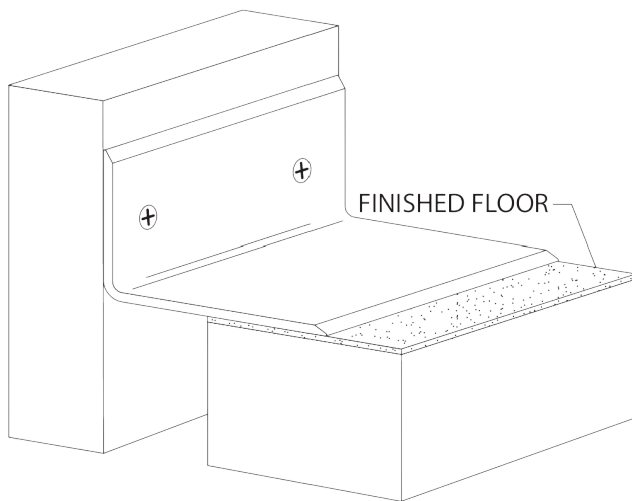

- Trim the aluminum plates to the required length.
- Position the plates over the structural gap.
- For floor to wall condition, short leg (predrilled hole side) should be placed firmly against the finished wall. Align level with the finished floor.
- Mark the locations of the pre-drilled holes on the substrate.
- Using a 1/8" (3mm) drill bit, drill into the marked locations on the substrate to a depth of 2-3/8" (60mm).
- Secure the plates in place by aligning them over the drilled holes and fastening them with flat head Tapcon screws.
- Clean the exposed surfaces thoroughly using a non-solvent cleaner.

Thank
You

The text "Thank You" is written in a black, elegant cursive script. The word "Thank" is on the top line, and "You" is on the line below it, positioned slightly to the left. The background features several overlapping, wavy, organic shapes in shades of pink and light blue, creating a soft, artistic backdrop for the text.

THE UNFOLDING JOURNEY CONTINUES TO REVEAL
NEW OPPORTUNITIES AND CHALLENGES AT EVERY
STEP

