

# EXPANZO

THE COMPLETE EXPANSION JOINT SYSTEMS







[WWW.EXPANZO.COM](http://WWW.EXPANZO.COM)

## EXPANZO SEAL SERIES

E P D M Extruded elastomeric Seal.



### Technical Data.

	Movement Rating $\pm 50\%$				
Product Guide					
	Thermal	Exterior	Interior	Fire Rated Option	Vapor
					ADA Compliant

- Heavy pedestrian / light duty vehicular loading capabilities.
- Appropriate for horizontal & vertical applications where watertight conditions are required.
- Comprised of a tough synthetic rubber. Superior movement while being highly resistant to UV degradation, extreme temperatures, and chemicals.
- Heat weldable for watertight seams & transition points.
- Industry unique profile ensures against waviness or bulging while addressing high load resistance.
- Unique design incorporates ribs on side faces to aid in pooling epoxy and adding surface area for increased adhesion.
- Profile engineered for improved ease of installation.
- Available in standard colour black. Colour Seals available- Contact your Rep. for more information.
- Lateral shear capable to  $25\% \pm$  nominal joint width. Application System Nominal Joint Width.



Application	System	Nominal Joint Width Install Range		H1		H2	
				Seal Height		Installed Depth	
		Inch	mm	Inch	Mm	Inch	Mm
<b>Architectural Compression Seals.</b>		¾ - 1 ¼	19 - 32	2	51	2 3/16	56
		1 5/8 - 2 3/8	41 - 60	2 3/16	56	2 3/8	60
		2 ½ - 3 3/8	63 - 86	3 5/16	84	3 ½	89
		3 ½ - 4 3/8	89 - 111	3 5/16	84	3 1/2	89

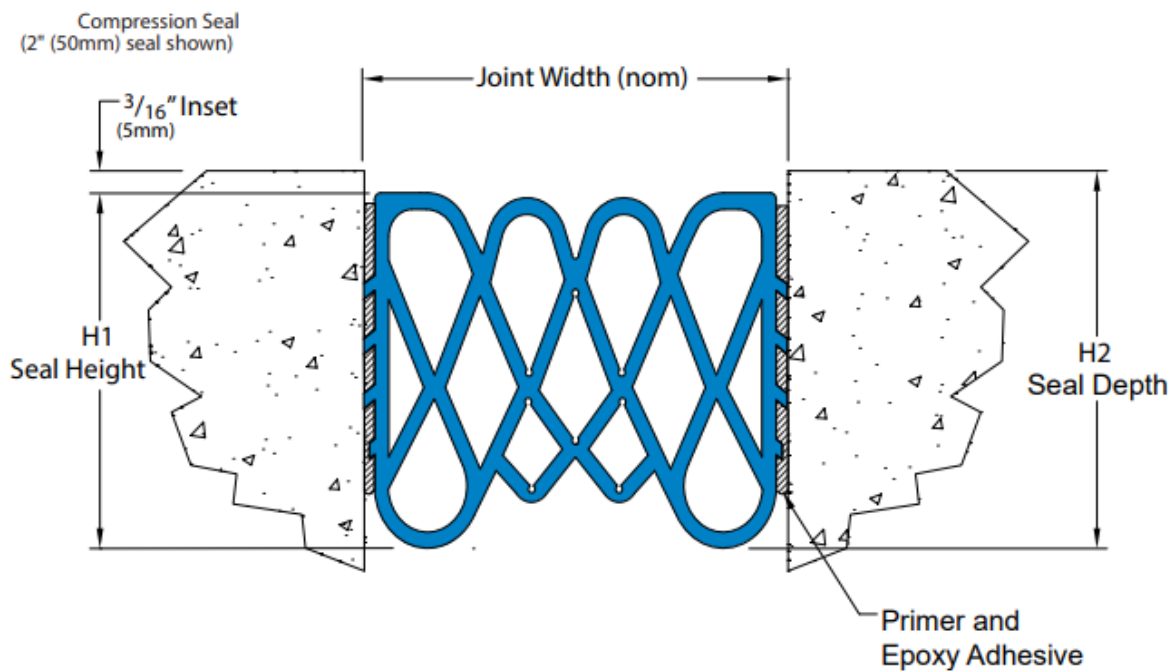

**Additional Information:**

- Install Condition: Horizontal and Vertical applications where watertight conditions
- are required
- Movement: +/- 50%
- Joint width: 1"-4"
- Optional fire rated
- Heavy pedestrian/moderate vehicular loading
- Heat weldable for watertight seams
- Standard Color: Black
- For premium and custom colors, minimum run lengths and increased price point apply.





CAD Drawings:

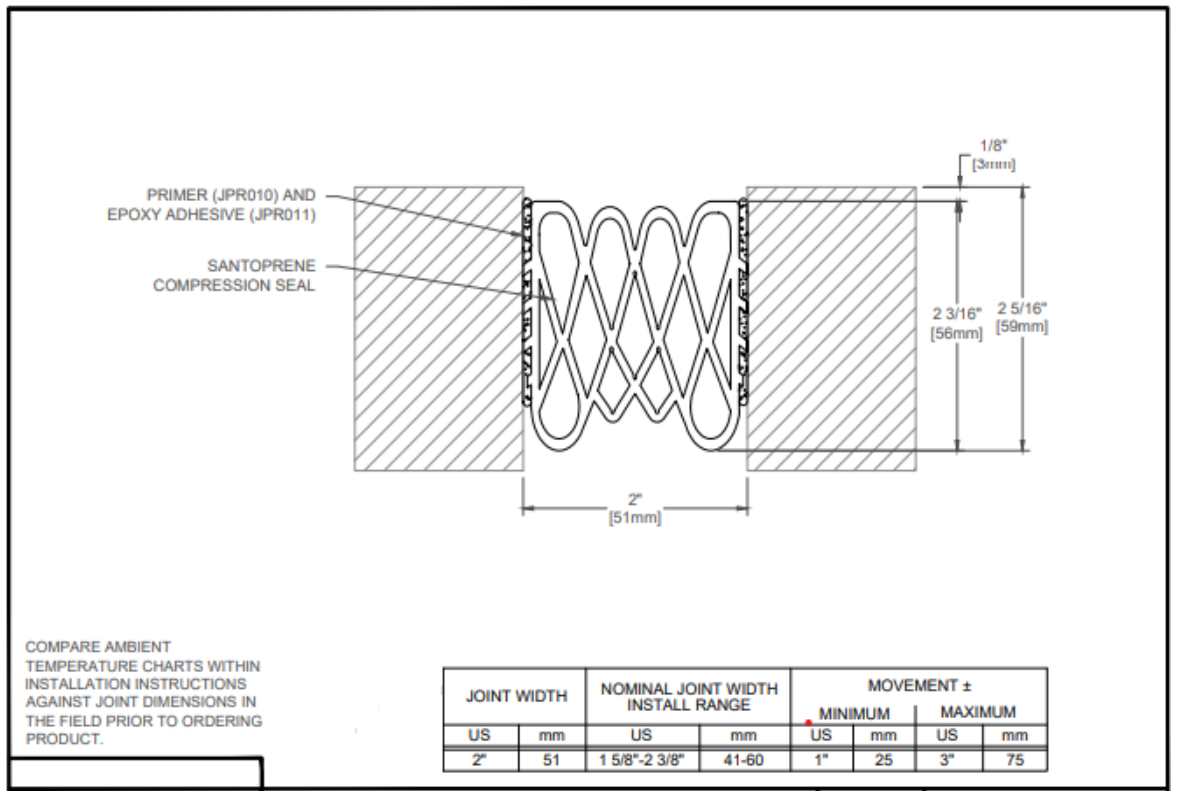
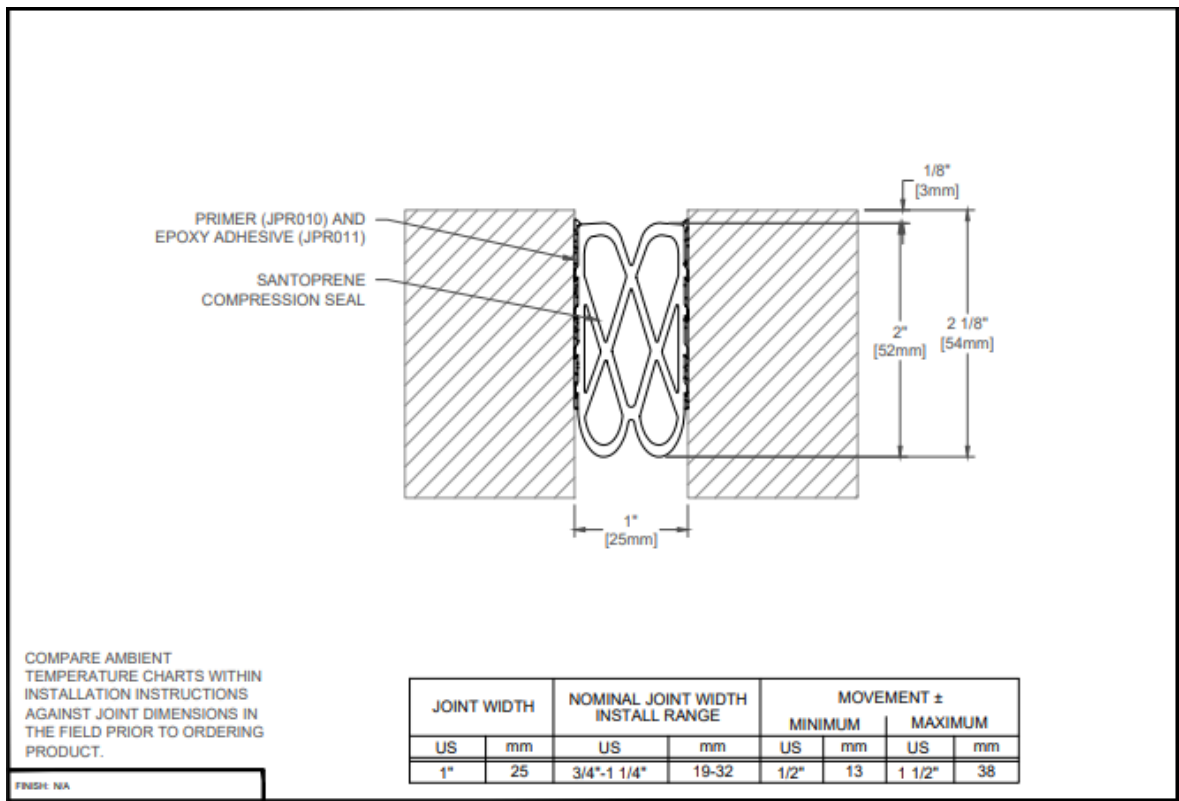

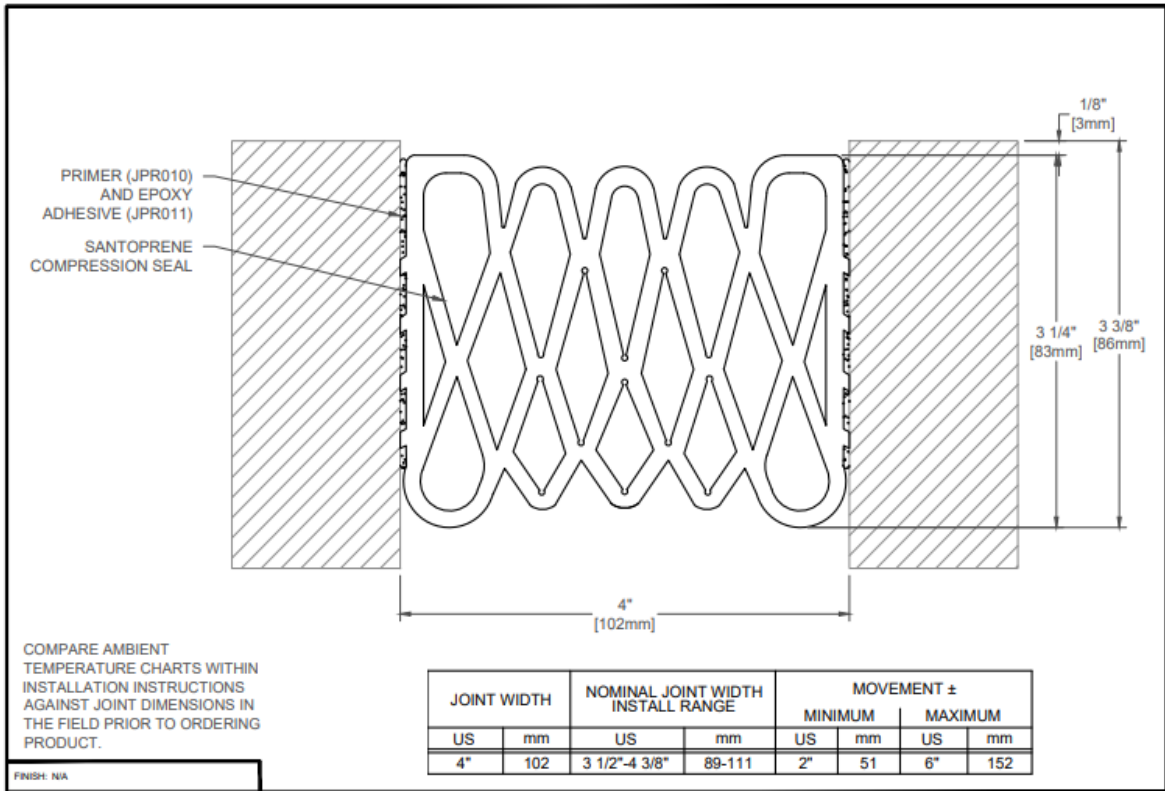
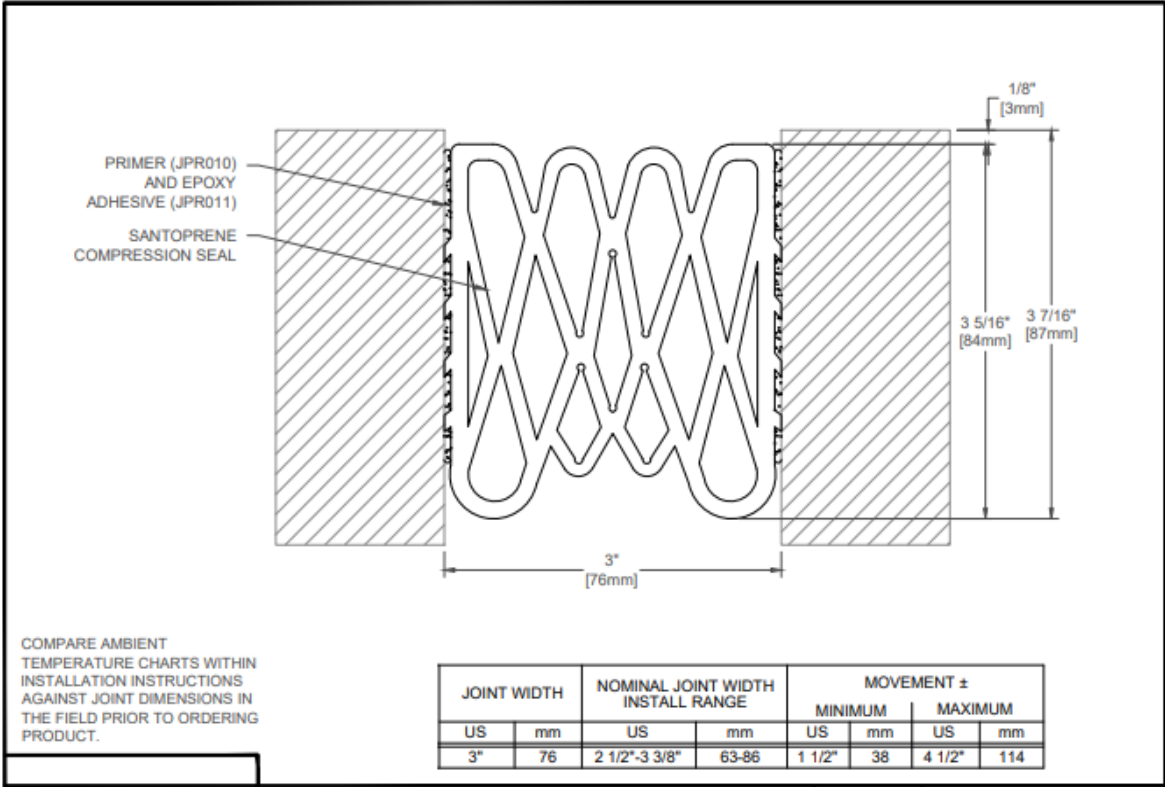

Figure 1

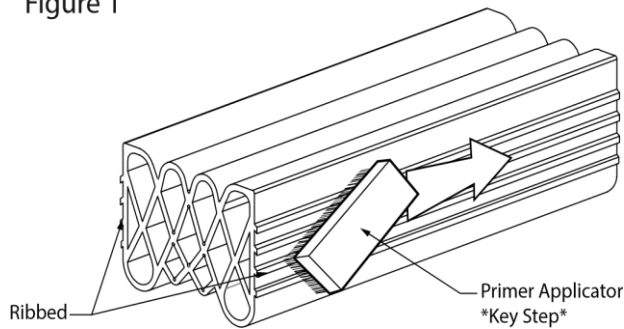
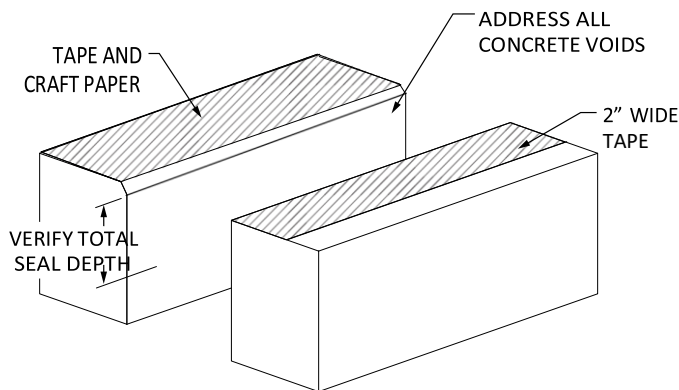

Figure 2



## Installation Process:

### Primer and Seal Preparation.

Figure 1

- Reference the primer and epoxy SDS sheet for safety precautions.
- Using a wire brush scrub the sides of the seal.
- Using a small brush, apply primer to the entire length of both ribbed side walls. Allow primer to dry for 15 minutes minimum to improve adhesion with joint opening. The primer chemically “prepares” the seal for epoxy adhesion.

Figure 2

- Line the edge of the structural joint with 2” wide tape, such as blue painters tape or duct tape.
- The finished installed depth is critical to compression seal performance, make sure seal is installed to proper depth.
- Prep edge of joint by placing duct tape along one side to keep the concrete clean. Along the adjacent edge of joint use tape and craft paper to allow an area for prepping the seal and keep the area clean. Tape the top of seal. (see Figure 3) Seal Height + 1/4”[6mm] = Total Seal Depth  
NOTE: If the seal is too deep, the joint may gather debris such as rocks, or nails which may cause



damage to the seal or joint face. If the seal is too shallow, the seal may receive abrasive wear from tire contact or be pulled out by snowplows.

- The ideal depth is 3/16" [ 5mm] below the joint edge. When seal is installed in a joint with a beveled edge, the top surface off the seal should be installed 1/16" [2mm] below the bottom of the bevel (see Figure 4).

### Installation of Seal

**Figure 3**

- Storage temperature is 40°-95°F (4°-35°C). Before use material temperature is 65°-75°F (18°-24°C).

WARNING: For hot weather installs, keep epoxy coat in an ice chest (cooler) and mix epoxy in smaller batches to increase workable time. For cold weather, ensure components do not freeze and temperature is a minimum of 47°F (7°C).

- Apply primer directly to side of seal (as noted in figure 1) prior to mixing the epoxy.
- Combine part A and B together in the proper ratio. Thoroughly mix using low speed drill (400 to 600 RPM) and paddle mixer for 3 minutes, until a uniform grey colour is achieved.

TIP: The faster the epoxy is removed from the mixing can and applied, the longer it lasts.

**Figure 3**

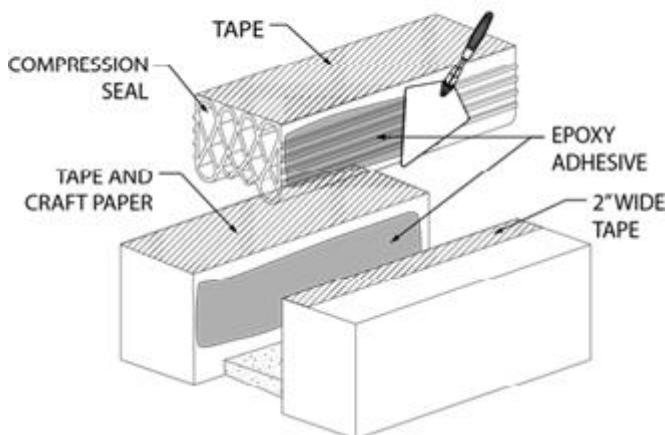
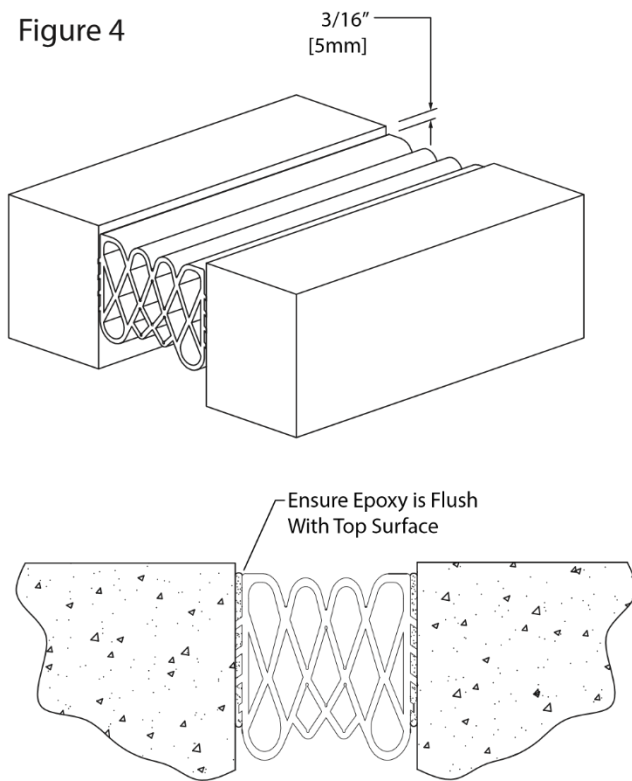

Figure 4



- Epoxy should be applied to both the inside joint walls and ribbed walls of the seal using a margin trowel or chip brush.
- Compress seal and insert into expansion joint opening, starting from one end and working toward the end condition before loading.
- Allow the adhesive to cure 24 hours (at 70° F / 21° C). Maximum bond strength (at 70° F / 21° C) is usually achieved within 48 hours.

Figure 4

- As seal is installed, clean the visible surface and ensure epoxy has been filled flush to top surface. A margin trowel may be used to remove any excess adhesive. **DO NOT ALLOW ADHESIVE TO CURE BEFORE CLEANING.**
- Once installation is complete, remove tape from joint edge and butt ends of the joint material (if used). Clean any adhesive off of joint surface.

**IMPORTANT:** If a installation can not be completed, leave approx. 2'-0" [60cm] of seal and substrate free of epoxy for later splicing and installation. **PROTECT PRODUCT FOR DURATION OF CONSTRUCTION UNTIL SIGN OFF BY OWNER.**



## Butt End Intersections.

Figure 5

- Add approximately 1/2' - 1" extra material at seams to ensure that the seam is in compression after installation.
- Verify that the new piece of material is cut square to existing material and not at an angle.
- Using a Waterstop Splicing Flat Iron, heat both faces at medium high (4250 F / 2180 C) for 30-45 seconds maximum to be adhered. Once material of the heated area begins to curl, remove heat welder plate and use pressure to adjoin the faces together along the entire perimeter. Allow product to cool prior to install.
- At "T" and "Cross" intersections install horizontal material first. Butt the vertical material up to the horizontal material.

## 45° & 90° Horizontal & 90° Vertical Intersections.

Figure 5

- Using a Miter Box, cut the seal with a smooth edge blade. Use denatured alcohol in a spray bottle liberally to assist in precision cutting. For a 90° angle, cut the two pieces to be mitered to  $480 \pm$

Figure 5

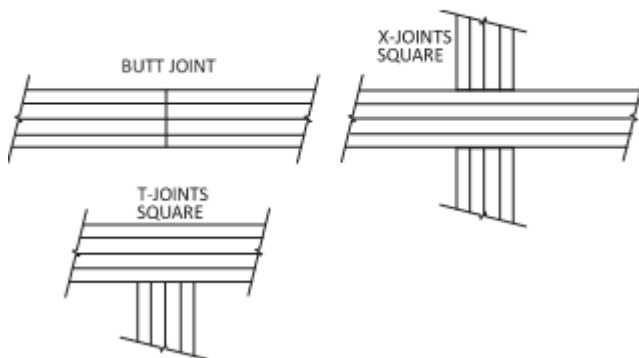

- Using a Water stop Splicing Flat Iron, heat both faces to be adhered, as per instructions above.

\*IMPORTANT : If a splice is to be made because the installation cannot be completed, leave approx 2'- 0" (600 mm) of seal substrate free of epoxy for later splicing.



Thank  
You

The text "Thank You" is written in a black, elegant cursive script. The word "Thank" is on the top line, and "You" is on the line below it. The text is centered horizontally. Behind the text, there are several overlapping, wavy, organic shapes in shades of pink, light blue, and lavender, creating a soft, artistic background.



THE UNFOLDING JOURNEY CONTINUES TO REVEAL  
NEW OPPORTUNITIES AND CHALLENGES AT EVERY  
STEP

